

Trimo modular space solutions



Kindergarten Biba, Škofja Loka, Slovenia

Education

Where additional space is required quickly and efficiently, Trimo's modular units are the perfect solution for creating larger classrooms, complete schools, kindergartens, playrooms and many other educational applications. The units are flexible in dimensions and materials so that the perfect environment can be created for children.

Living conditions in Trimo's buildings are in compliance with all standards and regulations, and the use of top-quality contemporary materials and advanced manufacturing procedures guarantee long life-span. With the highest fire ratings and load bearing (earthquake and wind loads) capacities Trimo's modular units are always safe and secure.

Trimo

- One of the leading providers of modular solutions.
- 25 years of experience.
- Almost 100,000 units manufactured and supplied in more than 40 countries worldwide.
- Highly experienced engineering, production and sales teams.
- Holding ISO 9001, ISO 14001, BS OHSAS 18001 and CE certificates.

References

- Faculty of Medicine, Ljubljana, Slovenia
- Kindergarten Biba, Škofja Loka, Slovenia
- Kindergarten Ajda, Ravne na Koroskem, Slovenia
- School, Salzburg, Austria
- Kindergarten, Wien, Austria
- School, Ilinden, Macedonia
- School and Kindergarten, Norway
- School, Bolzano, Italy
- School, Port au Prince, Haiti
- School and Kindergarten Montessori, Köln, German
- Kindergarten, Podpeč, Slovenia

Kindergarten Ajda, Ravne na Koroskem, Slovenia

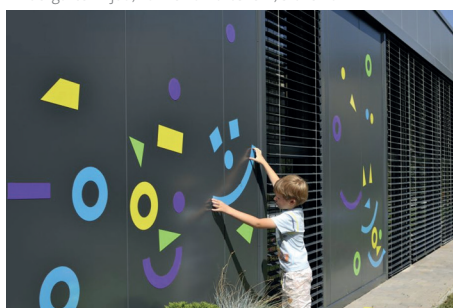

Kindergarten, Podpeč, Slovenia

Kindergarten Biba, Škofja Loka, Slovenia



Faculty of Medicine, Ljubljana, Slovenia



Efficient, Innovative, Sustainable Trimo modular space solutions

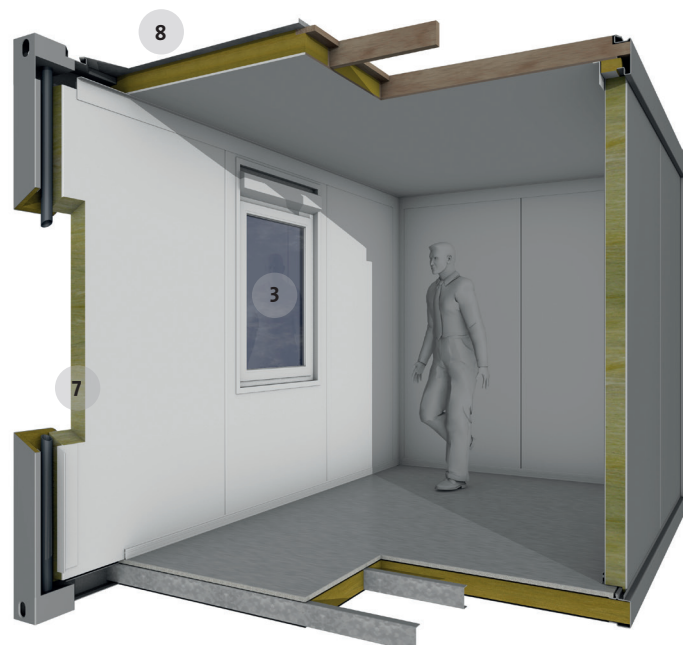

Modular Unit

1. **Reinforced steel framework**
Highest quality steel can be additionally coated and galvanized for use in the toughest climatic conditions. Steel construction is designed for easy handling and linking and also includes rainwater draining within the corner pillars.
2. **Easy to transport and re-locate**
Can be transported assembled due to special integrated vertical and horizontal reinforcements.
3. **Windows & Doors**
Standard or non-standard windows made in EU with CE mark are available. Insulation of windows as high as $U=0.7 \text{ W/m}^2\text{K}$.
4. **Long term economic benefits**
Can be assembled and disassembled a minimum of 3 times and can therefore be used on many consecutive projects and over a long time period.
5. **Tailor made solutions in accordance with customer needs**



Façade Panels

6. **Thermal and sound insulation**
Using various Trimo FTV fireproof panels of 60 to 133 mm thickness, thermal conductivity values (U) as low as $0.30 \text{ W/m}^2\text{K}$ can be guarantee as well as an R_w sound reduction of 32 dB.
7. **High Density Rock Wool**
 $100-120 \text{ kg/m}^3$ assures vertical consistency and prevents heat bridges during the complete life span of the product.
8. **Completely fire proof solution**
Walls, floors and ceilings are made of "A1" class non - combustible materials, are completely recyclable and environmental friendly. EI Fire resistance class certified (EI30 - EI120).
9. **Various profiles and custom colours**
Various faced profiles are available to meet customers' demands and any colour from the RAL colour-chart.

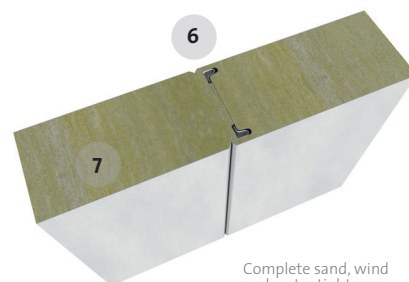

Complete sand, wind and water tightness

