

Trimo modular space solutions



Accommodation Units and Medical Facility, Bugojno, Bosnia and Herzegovina

Efficient, Innovative, Sustainable Trimo modular space solutions



Modular Unit

1. **Reinforced steel framework**
Highest quality steel can be additionally coated and galvanized for use in the toughest climatic conditions. Steel construction is designed for easy handling and linking and also includes rainwater draining within the corner pillars.
2. **Easy to transport and re-locate**
Can be transported assembled due to special integrated vertical and horizontal reinforcements.
3. **Windows & Doors**
Standard or non-standard windows made in EU with CE mark are available. Insulation of windows as high as $U=0.7 \text{ W/m}^2\text{K}$.
4. **Long term economic benefits**
Can be assembled and disassembled a minimum of 3 times and can therefore be used on many consecutive projects and over a long time period.
5. **Tailor made solutions in accordance with customer needs**

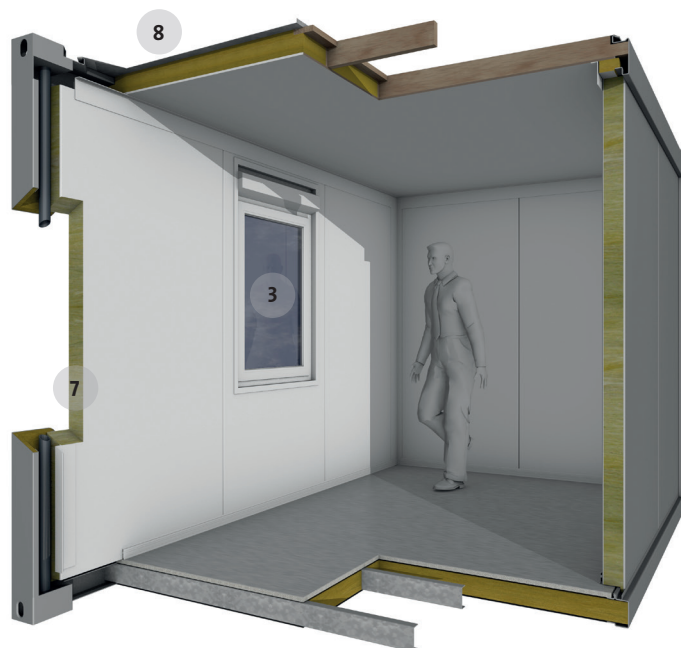

Façade Panels

6. **Thermal and sound insulation**
Using various Trimo FTV fireproof panels of 60 to 133 mm thickness, thermal conductivity values (U) as low as $0.30 \text{ W/m}^2\text{K}$ can be guaranteed as well as an R_w sound reduction of 32 dB.
7. **High Density Rock Wool**
 $100\text{--}120 \text{ kg/m}^3$ assures vertical consistency and prevents heat bridges during the complete life span of the product.
8. **Completely fire proof solution**
Walls, floors and ceilings are made of "A1" class non-combustible materials, are completely recyclable and environmental friendly. EI Fire resistance class certified (EI30 - EI120).
9. **Various profiles and custom colours**
Various faced profiles are available to meet customers' demands and any colour from the RAL colour-chart.

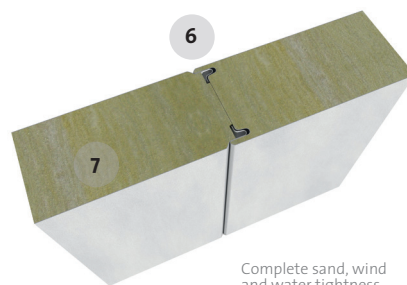

Complete sand, wind and water tightness

